

GENERAL PRICE LIST

Prices Effective October 1, 2008

*Supersedes all previous pricing
Prices are subject to change without prior notice*

This general price list covers Ratio:Feeder[®] brand injectors (dosing pumps), Ratio:Guard[®] Monitors, accessories and common parts. For pricing of parts not listed here, please refer to our Parts Price List.

PAYMENT TERMS

CREDIT CARDS - We accept MasterCard[®], VISA[®], and Discover[®]

CREDIT ACCOUNTS - Open account terms are offered to firms with satisfactory credit ratings. Open account terms are at the sole discretion of H.E. Anderson Company. Schools, state and local governments and federal agencies have open account terms, provided there is a written purchase order. Please contact H.E. Anderson Company if you would like to apply for open account terms.

OTHER - All others, payment with C.O.D., Cash In Advance, Money Order, or Cashiers Check.

INVOICING

There is a \$5.50 service charge for any order less than \$25.00 net. There may be additional charges for any additional forms, certified drawings, or other requirements requested by the customer.

RETURNS

Before returning items for warranty replacement or credit inspection, you must call H.E. Anderson Company for a Return Materials Authorization (RMA) number. RMA numbers may be obtained by calling (800) 331-9620 or (918) 687-4426 weekdays, 8:00am to 4:30pm central time. Returns for credit are limited to transactions less than six(6) months old, and are subject to a 20% restocking charge. Collect shipments will not be accepted.

PRICE QUOTATIONS

Only written, dated quotations will be honored. All other pricing is subject to change without notice. We are not responsible for typographical errors. All pricing is F.O.B. Muskogee, Oklahoma, USA, and will be the price in effect at the time the order was received, if standard shipping terms apply. For blanket orders or delayed shipment orders, the price will be that in effect at time of shipment.

REPAIRS

Call for an RMA Number before returning equipment for repair. Send equipment prepaid to **H.E. Anderson Co. 2100 Anderson Drive, Muskogee, OK 74403**. Include chemical valves, but do not leave them attached to pumper. Include your billing and shipping addresses, and record the model and serial numbers for your records. Please include a note with a brief description of the problems you are experiencing. Please include a UPS delivery address. Below is a schedule of service charges....

REBUILD LIKE NEW - \$60.00 labor plus parts at our discretion, replacement of missing or damaged parts, including valves, tubing, & cosmetic defects. Six(6) month warranty.

REBUILD - \$60.00 labor plus parts at our discretion. Six(6) month warranty.

REPAIR - \$60.00 labor plus parts at *customer's* discretion.

There is a \$35.00 labor charge for each additional pumper.



ANDY & ANDY JR. SERIES INJECTORS

Not just for large facilities any more! Same quality as our larger systems built in to this compact and yet very affordable design. Comes partially pre-assembled for easy installation. Requires 120VAC or 12VDC power.



Andy Series (DD)

1-1/4" Fittings, 3/4-50 GPM

Model	Description	Price
DD100	1:100 to 1:1000 Ratio	\$1500.00
DD100W	1:100 to 1:1000 Ratio, Wall Mount.....	\$1767.00
DD200	1:200 to 1:2000 Ratio	\$1500.00
DD200W	1:200 to 1:2000 Ratio, Wall Mount.....	\$1767.00
DD400	1:400 to 1:4000 Ratio	\$1500.00
DD400W	1:400 to 1:4000 Ratio, Wall Mount.....	\$1767.00
DD1000	1:1000 to 1:10000 Ratio	\$1500.00
DD1000W	1:1000 to 1:10000 Ratio, Wall Mount..	\$1767.00
DD1200	1:1200 to 1:12000 Ratio	\$1500.00
DD1200W	1:1200 to 1:12000 Ratio, Wall Mount..	\$1767.00

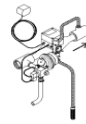

Andy Jr. Series (DB)

1" Fittings, 1/4-20 GPM

Model	Description	Price
DB100	1:100 to 1:1000 Ratio	\$828.00
DB100W	1:100 to 1:1000 Ratio, Wall Mount.....	\$1095.00
DB200	1:200 to 1:2000 Ratio	\$828.00
DB200W	1:200 to 1:2000 Ratio, Wall Mount.....	\$1095.00
DB400	1:400 to 1:4000 Ratio	\$828.00
DB400W	1:400 to 1:4000 Ratio, Wall Mount.....	\$1095.00
DB1000	1:1000 to 1:10000 Ratio.....	\$828.00
DB1000W	1:1000 to 1:10000 Ratio, Wall Mount..	\$1095.00
DB1200	1:1200 to 1:12000 Ratio.....	\$828.00
DB1200W	1:1200 to 1:12000 Ratio, Wall Mount..	\$1095.00
DB1200LP	1:1200 to 1:12000 Ratio, Low Pressure	\$876.00

Accessories

For Andy, Andy Jr., & Portables

Model	Description	Price
20710	1.9 Gallon Blend Tank (Inc. w Wall Mount).....	\$197.00
19076	Totalizer/Counter (s/n AD & after)	\$164.32

Portable Models

Model	Description	Price
DB100PB	1:100 to 1:1000 Ratio w/Battery	\$1917.00
DB100P	1:100 to 1:1000 Ratio	\$1681.00
DB1000PB	1:1000 to 1:10000 Ratio w/Battery	\$1917.00
DB1000P	1:1000 to 1:10000 Ratio.....	\$1681.00

RATIO:GUARD[®] MONITORS

An excellent add-on to any system. Provides constant monitoring of your water. Alarm setpoints and relay outputs allows for extra control of your injection system.



Monitors/Controllers

All monitors include cables, probes & Serial I/O

Model	Description	Price
EC Monitor/Controller		
E-1S	EC Monitor/ w/ Sensors.....	\$780.00
pH Monitor/Controller		
P-1S	pH Monitor w/ Sensor.....	\$1014.00
Tank Level Monitor/Controller		
L-1S	Tank Level Monitor w/ Sensor.....	\$841.00

RS-485 serial port is standard on all units

Accessories

For In-Line EC, pH & Tank Level Monitors

Part No.	Description	Price
06916	pH Calibration Kit.....	\$18.30
06924	pH Calibration Pillows(10 each/7&4).....	\$21.10
11494	pH Probe, Replacement	\$273.60
19643	Probe Tee, Vented, pH/Temp only.....	\$51.50
19632	Probe Tee, Un-vented, Any probe	\$43.00
19654	Retainer Pin, U-shaped	\$4.93
14978	EC/Temp Cable, 25'	\$33.85
14960	pH Cable, 25'.....	\$67.00
11501	Temp Sensor, Less Tee	\$105.20
11519	EC Sensor, Less Tee.....	\$133.10
03110	Transducer for Level Monitor	\$453.60

ACCESSORIES & REPAIR KITS

Ratio:Feeder® Accessories

Part No.	Description	Price
High Capacity Fittings		
20976	VMC3 Check Valve	\$251.00
21209	Injection Point Fitting for VMC3	\$65.00
20998	VMC3 Combo (20976 & 21209)	\$315.00
12434	Bulkhead Strainer.....	\$44.10
19543	Suction Pipe for 1/2" ID Tubing	\$65.40
12063	Tubing, 1/2" ID, Braided (per foot)	\$2.89
13341	Foot Valve/Flush Fitting 1/2".....	\$29.95
Standard Capacity Fittings		
06742	Suction Valve (Single Ball)	\$14.10
02857	Discharge Valve (Single Ball)	\$18.70
09812	Double Suction Valve.....	\$22.10
09812G	Double Suction Valve w/ Springs.....	\$29.70
09275	Double Discharge Valve.....	\$29.00
09275G	Double Discharge Valve w/ Springs	\$36.80
09820	Single Valve to Double Converter.....	\$10.02
07288	Universal Suction Fitting.....	\$27.40
09838	Plain IPF, 1/2"	\$22.50
03830	Priming IPF, 1/2"	\$68.00
04094	Universal IPF, 1/2"	\$96.00
17087	Suction Pipe for 1/4" ID Tubing	\$45.80
06892	Tubing, Black, 3/8" OD (per foot).....	\$2.24
06909	Tubing, Clear, 3/8" OD (per foot).....	\$1.21
13334	Foot Valve/Flush Fitting 1/4".....	29.95
Other Accessories		
08649	Calibration Standpipe	\$139.40
07238	Waterproof Grease, Packet	\$1.48
03681	Waterproof Grease, 10oz Tube	\$26.80
12153	Silicone Grease, Packet	\$3.77
19609	Poppet Spring (Hastelloy C).....	\$3.91

Ratio:Feeder® Repair Kits

Part No.	Description	Price
High Capacity Fittings Kits		
21010	VMC3 Rebuild Kit	\$37.90
20876	VMC2 Rebuild Kit	\$37.90
Standard Capacity Fittings Kits		
06735	Ball Poppet Kit, CV	\$10.29
01991	Ball Poppet Kit, SSV	\$6.25
19898	Ball Poppet Kit w/ Springs.....	\$18.00
05404	IPF Kit 1/2" (for P/N 04094)	\$24.50
Pilot Valve Kits		
19043	Repair Kit for 3/4" Type A	\$59.90
19065	Repair Kit for 1/2" Type A	\$65.60
19032	Cable w/ Plug for Type A & AS	\$25.80
Pumper Diaphragm Kits		
17032	Kit for A3/T4, Teflon®	\$125.90
08913	Kit for P1,P2,H1,H2, Hypalon®/EPDM	\$104.00
20798	Kit for A10, Teflon®	\$166.80
08939	Kit for H4,P4, Hypalon®/EPDM	\$110.00
10661	Kit for P1,P2, Hypalon®/EPDM Low PSI....	\$107.66
18932	Kit for A20, Teflon®	\$255.64
Series SD Water Motor Kits		
06751	Maincase Kit.....	\$21.36
12070	Upper Maincase Rebuild Kit	\$115.60
17605	Arm Retainer/Ball Pivot Kit.....	\$19.70
09317	R-Valve, Complete	\$24.40
01975	P-Valve, Complete.....	\$18.70

Pumper/Manifold Stands

Part No.	Description	Price
19810	Stand for Andy/Andy Jr. Series.....	\$43.35
16521	Stand, Multi, SS.....	\$63.45
16532	Stand, Single, SS	\$76.07
19510	Stand, Type AS Floor Mount, SS	\$82.89
19598	Stand, Type AS Wall Mount, SS	\$64.50
07922	Manifold Adder Kit	\$47.98



H.E. Anderson
COMPANY
 Muskogee, OK 74402-1006
 Phone 1-800-331-9620

J PLUS SERIES INJECTORS (Component Pricing)

The J Plus Series dosing pumps provide the flexibility that today's growers need and want. Add any solution at any time. Multiple chemical injection. Easily expandable and adjustable. Wide water flow ranges. Pick one item from each of the five(5) categories (J Plus Controllers, Pumper Manifolds, Water Meters, Pumps, and Blend Tanks).

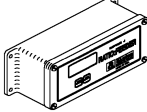

J Plus Controllers

2-Output & 4-Output Configurations

Model	Description	Price
15909S	J Plus 2-Output, 120VAC	\$871.00
17632S	J Plus 2-Output, 12VDC	\$871.00
15899S	J Plus 4-Output, 120VAC	\$999.00

RS-485 serial port is standard on all units

Optional FertiCom® PC Software

18710	FertiCom® Software.....	\$859.00
	w/ RS232-RS485 Converter (Windows® 98 or later)	
14431	2-Conductor Serial Cable/Foot.....	\$0.81

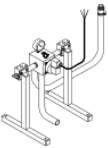

Pumper Manifolds

24VAC & 12VDC Configurations

24VAC Actuated

Model	Description	Price
40910	Manifold Single Type AS	\$500.60
42132	2 Pumper, 3/4" Fittings	\$587.00
42143	3 Pumper, 3/4" Fittings	\$622.00
42154	4 Pumper, 3/4" Fittings	\$656.00
42165	5 Pumper, 3/4" Fittings	\$692.00
42176	6 Pumper, 3/4" Fittings	\$727.00

12VDC Actuated

40921	Manifold Single Type AS	\$500.60
42076	2 Pumper, 3/4" Fittings	\$587.00
42087	3 Pumper, 3/4" Fittings	\$622.00
42098	4 Pumper, 3/4" Fittings	\$656.00
42109	5 Pumper, 3/4" Fittings	\$692.00
42110	6 Pumper, 3/4" Fittings	\$727.00

Water Actuated

40932	Manifold Single Type AS	\$442.40
42010	2 Pumper, 3/4" Fittings	\$529.80
42021	3 Pumper, 3/4" Fittings	\$564.00
42032	4 Pumper, 3/4" Fittings	\$599.00
42043	5 Pumper, 3/4" Fittings	\$634.00
42054	6 Pumper, 3/4" Fittings	\$669.00

Water Meters

Pick one(1) meter listed below for each system

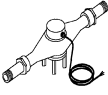

Brass Jet Meters

Includes connection couplings

Model	Description	Price
14125	3/4" 1/4-20 GPM	\$299.00
14176	1" 1/2-30 GPM	\$384.00
14184	1" 3/4-50 GPM	\$468.00
14192	1-1/2" 1.5-100 GPM	\$803.00
14209	2" 2-160 GPM	\$1231.00



PVC Flanged Turbine Meters

Requires 150lb. companion flanges
(not included)

Model	Description	Price
16609	2" 2-150 GPM	\$1295.00
16610	3" 4-400 GPM	\$1552.00
16621	4" 6-600 GPM	\$1817.00
16632	6" 12-1200 GPM	\$2218.00



Insertion Meters

Requires Meter & Tee/Saddle

Non-Adjustable Type

Model	Description	Price
08948	1.5-3" Insertion Meter	\$821.00
08956	4-8" Insertion Meter	\$895.00

PVC Tees & Saddles for Non-Adjustable Meters

19298	1.5" Tee 1.9-190 GPM	\$246.40
19309	2" Tee 3.1-314 GPM	\$188.65
19310	3" Saddle 6.9-691 GPM	\$306.08
19321	4" Saddle 12-1200 GPM	\$252.02
19332	6" Saddle 27-2700 GPM	\$290.68
19340	8" Saddle 47-4700 GPM	\$344.58

Adjustable Type

Model	Description	Price
18853	10-48" Insertion Meter	\$1515.00

Saddles for Adjustable Meter

18832	10" Saddle 74-7370 GPM	\$156.20
18843	12" Saddle 105-10470 GPM	\$191.70

J PLUS SERIES INJECTORS (Component Pricing, continued)

The J Plus Series dosing pump provides the flexibility that today's growers need and want. Add any solution at any time. Multiple chemical injection. Easily expandable and adjustable. Wide water flow ranges. Pick one item from each of the five(5) categories (J Plus Controllers, Pumper Manifolds, Water Meters, Pumps, and Blend Tanks).

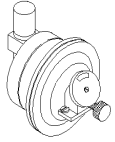

Standard Pumpers

Other Options Available
Consult Factory

Model	Description	Price
A3-VCP	3ml (PVC, Teflon®)w/ Suction Pipe.....	\$682.00
A10-VCP	10ml (PVC, Teflon®)w/ Suction Pipe...	\$718.00
H1-HD	10ml (PVC, Standard Diaphragm)	\$628.00
H1-CD	10ml (Acrylic, Standard Diaphragm)...	\$628.00
P1-BA	10ml (Acrylic, Standard Diaphragm)...	\$468.00
P1-HC	10ml (PVC, Standard Diaphragm)	\$573.00
P1-RC	10ml (PVC, Viton Diaphragm)	\$598.00
H2-HD	20ml (PVC, Standard Diaphragm)	\$628.00
H2-CD	20ml (Acrylic, Standard Diaphragm)...	\$628.00
P2-BA	20ml (Acrylic, Standard Diaphragm)...	\$468.00
P2-HC	20ml (PVC, Standard Diaphragm)	\$573.00
P2-RC	20ml (PVC, Viton Diaphragm)	\$598.00
A20-VCP	20ml (PVC, Teflon®)w/ Suction Pipe...	\$792.00
H4-HD	40ml (PVC, Standard Diaphragm)	\$670.00
H4-CD	40ml (Acrylic, Standard Diaphragm)...	\$670.00
H4-QD	40ml (Acrylic, Viton Diaphragm)	\$729.00

A,P pumpers come with ceramic check balls unless otherwise noted.
H pumpers come with stainless steel check balls.



Blend Tank

Model	Description	Price
07533	8 Gallon Blend Tank, Sch 80 PVC	\$649.00
	125 psi, 2" Fittings	
07541	Floor Base for Vertically Mounting	\$40.00
	07533 Blend Tank	

BUILDING YOUR SYSTEM

Build your own system by choosing components from the table listings. First choose type of controller; then the water meter size based on you maximum flow rate in GPM.

Blend tanks are sized according to water flow rate; use p/n 07525 for flows up to 200 GPM; use p/n 07633 for flows up to 1200 GPM.

Choose for each chemical solution, the size and number of pumpers needed by using the following formula: $Peak\ Water\ Flow \times 3.154 = \text{maximum ratio of one H4 pumper}(1)$. If the answer is smaller than your required ratio, then only one H4 pumper is needed. If the answer is larger, divide (1) by your ratio and round up to the next larger integer.

Select manifolds for this number. If (1) divided by your ratio is smaller than 0.5, use a P2 or A20 pumper. If it is less than 0.25 use a P1 or A10 pumper, and if less than 0.075 use an A3 pumper.

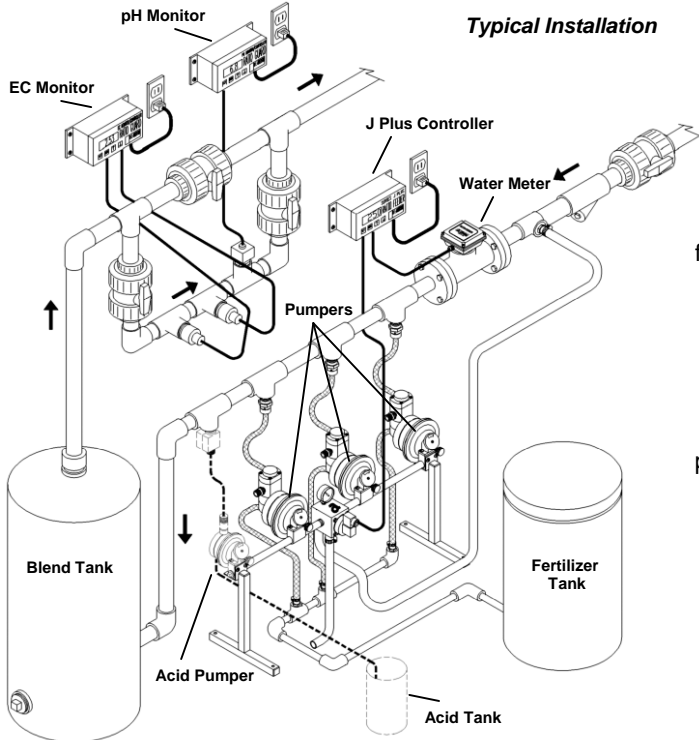

H.E. Anderson
COMPANY
 Muskogee, OK 74402-1006
 Phone 1-800-331-9620

SD SERIES DOSING PUMPS

The SD Series has provided accurate water treatment to some of the most remote areas in the world. Use the SD Series in applications where electricity is not available. Heavy duty, brass construction combined with Anderson quality, makes the SD Series a long-lasting, dependable, and accurate dosing pump.

SD Series

2" Flange fittings, 4-50 GPM Flow
Choose one option from each
of the 3 tables below

TABLE 1
Base Prices

Model	Capacity per stroke	Price
SD*0-	3 ml	\$1596.00
SD*1-	10 ml	\$1596.00
SD*2-	20 ml	\$1596.00
SD*4-	40 ml	\$1637.00

* This position is for the letter which designates the gear train. Consult factory for gear train options.

TABLE 2
Liquid End Options

Code	Price	Code	Price
B	N/C	U, V*	\$82.00
D	\$18.00	W*	\$105.00
H	\$30.00		

* U & W options for SD*0- units only. All others for SD*1-, SD*2-, and SD*4- units only.

TABLE 3
Other Options

Code	Description	Price
IPF Options		
A	Standard Injection Point Fitting	\$21.00
B	Priming Injection Point Fitting	\$68.00
C	Universal Injection Point Fitting	\$96.00
X	No Liquid End Fittings	*-\$16.00
* Credit		
Special Options		
R	Low Pressure (15-75 psi) (SD*1- & SD*2- only)	\$113.00

Accessories

Part No.	Description	Price
19909	3/4" x 2" Connection Flanges(Pair)	\$48.60
19910	1-1/4" x 2" Connection Flanges(Pair) ...	\$48.60
19921	1-1/2" x 2" Connection Flanges(Pair) ...	\$45.10

See previous page for Blend Tanks

SD Hypochlorinators

Model	Description	Price
SDN2-BA	1:1260	\$1617.00
SDN2-BAR	1:1260, Low Pressure.....	\$1730.00

Other hypochlorinator models available. Call for sizing.

Standard Series SD Water Motor Controls

Use with a pumper from page 5

Model	Stroking Rate	Price
SDJC-0	9.14 Gallons flow per stroke	\$1150.00
SDNC-0	6.64 Gallons flow per stroke	\$1150.00
SDXC-0	3.37 Gallons flow per stroke	\$1150.00
SDND-0	3.32 Gallons flow per stroke	\$1150.00
SDXD-0	1.69 Gallons flow per stroke	\$1150.00

SD Series Pricing Example

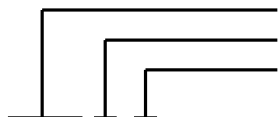

Base price from TABLE 1
Add price from TABLE 2
Add price from TABLE 3

SDN2- B A

$$\$1596.00 + \text{N/C} + \$21.00 = \$1617.00$$



H.E. Anderson
COMPANY
Muskogee, OK 74402-1006
Phone 1-800-331-9620