

J Air and Water Kit Instructions

Part# 02584

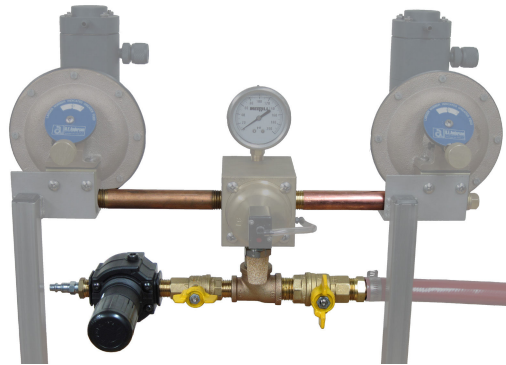

Unpacking

Please open and inspect your package upon receipt. Your package was packed with great care and all the necessary packing materials to arrive to you undamaged. If you do find an item that is broken or damaged, you must contact the delivering carrier to report the claim.

Getting Technical Assistance

H.E. Anderson Company is dedicated to assisting our customers with installation and use of our products. Our technical staff are available each weekday from 8:30am to 4:30pm central time. You may call us toll free at **1-800-331-9620** from anywhere in the U.S.A. and Canada. If no one is available, we will promptly return your call.

Before you call, we suggest that you review this manual. You may find the answer to your question here. But even if you do not, reviewing the manual will help us to help you.

If you need an additional owners manual for **any** H.E. Anderson Company product, please visit our website at <http://heanderson.com/manuals.php>

Safety Information

- Compressed air can be dangerous. Use caution when working with the system along with eye and ear protection.
- Do not exceed the pressure rating of any components in the system.
- Make sure never to open both valves on the air kit at the same time.
- Make sure the air and water pressure supplied to the pumper manifold does not exceed 125psi.
- Make sure the air pressure supplied to the air regulator does not exceed 300 psi.
- Release all pressure within the system before attempting to service any components.
- Check hoses for weak or worn condition before each use and make sure all connections are secure.
- Water, compressed air and environmental temperatures must stay within the range of 33°F to 140°F (1°C to 60°C).

Specifications

Compressed Air Charts for J Series Units

Number of Pump Heads	Pump Head Size	CFM "Free Air" Required
2 Pumpers	H4	9.0 CFM
3 Pumpers	H4	12 CFM
4 Pumpers	H4	15.5 CFM
5 Pumpers	H4	18.5 CFM
6 Pumpers	H4	22.0 CFM

Installation

1. Unpack contents and make sure all parts are present.
2. Remove the valve cable from the manifold valve. The phillips head screw holding the cable connector to the coil on the valve must be unscrewed.
3. Remove the pump heads from manifold to make moving the manifold easier.
4. Remove hosebarb from the "In" port on the brass valve on the manifold.
5. Wrap Teflon tape or apply pipe sealant around the exposed end of the 3/4" x 2-1/2" pipe nipple on the air kit manifold.
6. Screw the entire assembly into the "In" port on the brass valve on the manifold. Be careful not to cross thread the pipe. Remove the manifold stands if they interfere with installation and reinstall them after the air kit has been installed. If the manifold uses 3" pipe nipples then the extended pipe nipples may be required to avoid interference between the stands and the valves on the kit.
7. If the pumpers will be run using air, remove the hosebarb from the "Out" port and install the supplied air muffler in the "Out" port on the valve. If the pumpers will be run using water, leave the hose barb and drain hose installed on the valve.

Warning: The air muffler must be used when running the pumpers with compressed air. The drain hose must be used when running the pumpers with water. The appropriate fitting must be installed every time the pressure source is switched.

8. Make sure both valves on the air kit are closed and turn the knob on the air regulator counter clockwise to remove all the force on the regulating spring.
9. Reinstall the pump heads and valving if it was removed.
10. Install the water supply line using a hose clamp to ensure the connection does not leak.
11. Connect an air hose to the air fitting.
12. Before using the manifold with air, open the "T" handle ball valve on the air side of the air kit. The gage mounted on the manifold valve should read ~5psi if the regulator was adjusted as instructed. Adjust the regulator until the gage on the manifold reads the same as the water pressure in the water line being injected into.

J Air and Water Kit

Note: When adjusting air pressure, always approach the desired air pressure from a lower pressure. When reducing the pressure from a higher to a lower setting, first reduce to some pressure less than that desired, then bring up to the desired pressure. The knob can be locked by pushing down on it and unlocked by pulling up.

13. When switching to water pressure, make sure the valve on the compressed air side of the kit is closed first before opening the valve on the water side of the air kit.

Parts List

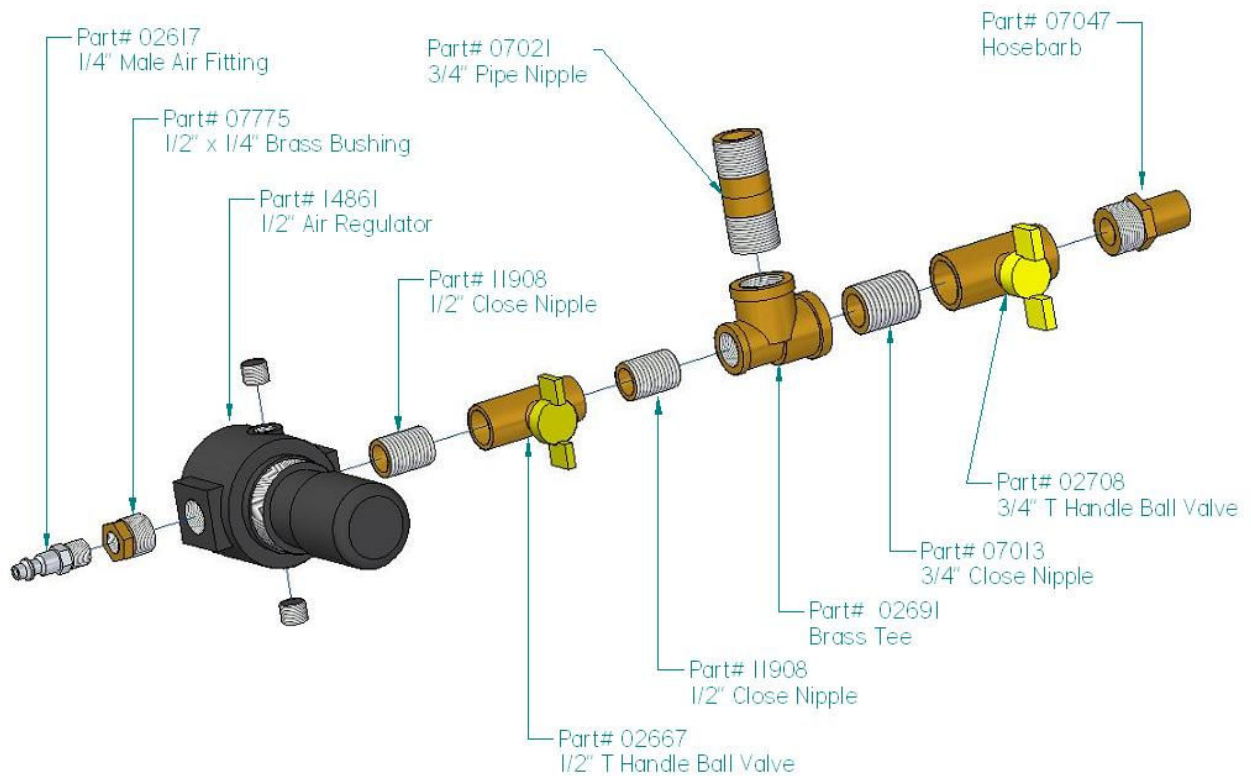

J Air and Water Kit

Troubleshooting

Possible causes and solutions.

Pumpers not injecting proper amount of chemical

- Refer to pumphead and manifold manual.
- Check all valves and connections are working and in the proper position.
- Check for ice accumulating on muffler.
- Ensure air pressure or water pressure supplied to manifold is the same as the water pressure in the line being injected into. Be careful not to exceed 125psi as

Ice accumulating on the air muffler

- Installing compressed air dryer.
- Upgrade to the heavy duty air muffler part# 02609.

