



04094  
Universal IPF

## UNPACKING

Please open and inspect your package upon receipt. Your package was packed with great care and all the necessary packing materials to arrive to you undamaged. If you do find an item that is broken or damaged, you must contact the delivering carrier to report the claim.

 **CAUTION**  
Follow safety  
procedures when  
dealing with acids or other  
dangerous chemicals.

# UNIVERSAL INJECTION POINT FITTING (IPF) INSTRUCTIONS

The Universal IPF performs multiple functions:

- **Check Valve** – Prevents discharge from the water line in case of a break in the discharge line
- **Priming Valve** – Vents the discharge line to allow easier priming of the metering pump
- **Anti-siphon Valve** - Shuts to prevent siphoning whenever there is a negative pressure at the injection point.
- **Limited Gravity Restriction** – Provides a nominal 7 psig restriction to the chemical side of the IPF. **NOTE:** *It cannot protect against chemical pressures which are more than 7 psig greater than the water line pressure.*

## GETTING TECHNICAL ASSISTANCE

**The H.E. Anderson Company** is dedicated to assisting our customers with installation and use of our products. Our technical staff are available each weekday from 8:30am to 4:30pm central time. You may call us toll free at **1-800-331-9620** from anywhere in the U.S.A. and Canada. If no one is available, we will promptly return your call.

**Before you call**, review this manual. You may find the answer to your question here. But if not, reviewing the manual will help us to help you.

If you need an additional owners manual for **any** H.E. Anderson Company product, please visit our website at <http://heanderson.com/manuals.php>



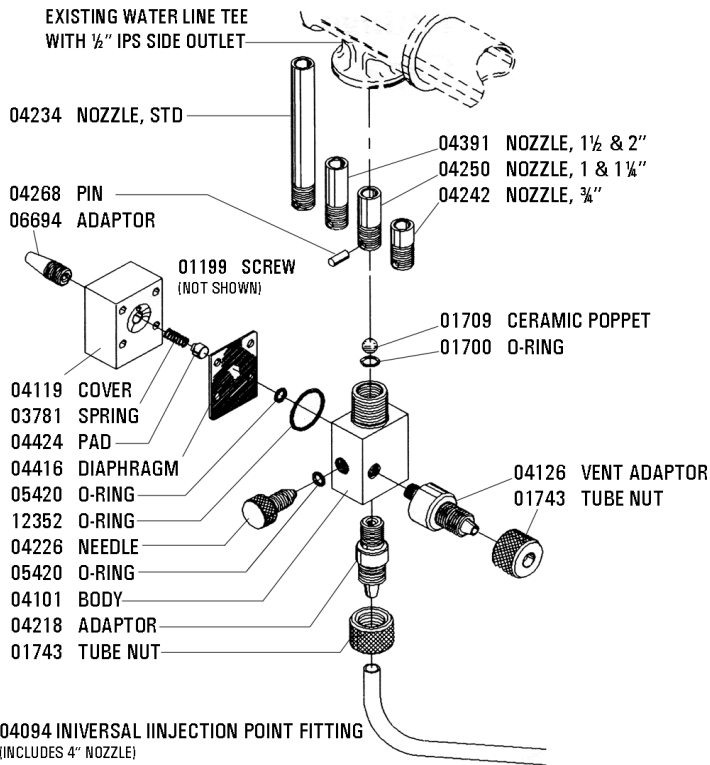

## Specifications Part No. 04094

### Materials

Body and fittings.....	PVC
Ball Poppet.....	Ceramic (SS Optional)
O-Rings .....	Viton® (Other options available)
Diaphragm .....	Viton®
Other parts .....	Stainless Steel

### Maximum Ratings

Flow.....	600 ml/min @ 50% duty cycle
Pressure.....	150 psig
Temperature .....	140°F (60°C)

so more convenient. Drain the chemical and flush with water.

Remove the four screws which retain the cover. The ball poppet should hold the water line pressure. Replace the diaphragm. Replace the cover. Make sure that the spring and pad are in the proper positions.

### Changing the Ball Poppet

Remove the universal IPF from the water line. Unscrew the nozzle. Replace the poppet and reassemble.

### Changing the O-Ring Seat

Removing the O-ring will usually damage it, so be sure you have a replacement O-ring before removing the old. Use a safety pin or similar tool to remove the O-ring. Spear the O-ring, but be careful not to push the point clear through the O-ring. Doing so will damage the valve body. Carefully pry the O-ring out of the groove. Use a small screwdriver to lift it out of the body. Wash the body and inspect the groove for scratches.

Install the new O-ring by inserting it sideways into the hole. Use the small screwdriver blade to gently place one side of the O-ring into the groove. Gently force the O-ring into the groove by rotating the valve body and gently pushing with the screwdriver. When the O-ring is in, rub it with the screwdriver blade to remove any twists in it. Now replace the ball and nozzle. Be sure the retaining pin is still in place.

## INSTALLATION

The priming IPF should be installed as nearly vertical as possible with the chemical entering from the bottom of the water line. **This is especially important when feeding acids.**

The IPF inlet connection is for 1/4" I.D. by 1/16" wall plastic tubing. Use polyethylene tubing for this connection. **Do not use clear vinyl tubing!**

The outlet fitting size is 1/2" NPT threads. The drain line will accept 1/4" I.D. plastic tubing. *This is optional, but recommended when using corrosive or dangerous chemicals.*

If you have the P/N 04234 standard nozzle on your IPF, you must cut it to fit. Cut it so the tip will extend midway into the pipe when installed.

Coat the pipe threads with a sealer-lubricant (Teflon tape or paste) to make removal easier. Screw the fitting into the injection point. **Note: Do not screw the fitting in too tight or you will damage it; hand tight should be good enough for most installations.**

Connect the metering pump discharge line between the pump and IPF. Connect the the drain hose, if used, and you are ready for operation.

## PRIMING

With the metering pump operating, open the knurled knob about one turn. The pump will be pumping to atmosphere and will probably prime itself. As soon as you see chemical coming from the drain, close the knurled knob by hand. **Do not use a wrench; you might damage the seat.** The system is now ready to operate.

## MAINTENANCE

The only routine maintenance needed is to inspect the ball poppet and injection nozzle every six months to see if they are in good condition.

Wash the IPF with water to prevent chemical deposits from building up and interfering with operation.

## REPAIR



### Replacing the Diaphragm

It is not necessary to remove the universal IPF from the water line, although you may find doing

# H.E. ANDERSON COMPANY LIMITED WARRANTY

## WHAT IS COVERED

The H.E. Anderson Company of Muskogee, Oklahoma, will make any necessary repairs and/or replace any parts of this H.E. Anderson Company product made necessary because of defects in materials or workmanship for fifteen months from date of manufacture. Warranty repairs and/or replacements will be performed without charge to the owner by H.E. Anderson Company within a reasonable time after prepaid delivery of the defective product to the H.E. Anderson Company, 2100 Anderson Drive, Muskogee, Oklahoma 74403.

## WHAT IS NOT COVERED

This warranty specifically excludes failure of any parts or materials caused by chemical attack or damage caused by operation above rated capacity or pressure. Further, this warranty does not cover wear or failure caused by sand or other foreign materials which may be found in water that is passed through our products, or damage caused by freezing or exposure to water temperatures above 60°C (140°F).

This warranty does not cover damage caused by failure to follow prescribed installation instructions and limitations issued by H.E. Anderson Company. In addition, this warranty does not cover service adjustments, repairs, or replacements caused by misuse, negligence, alteration, accident, or lack of specified maintenance.

This warranty does not cover components used by, but not manufactured by H.E. Anderson Company, in the manufacture of our products except to the extent of said component manufacturer's warranty.

This warranty specifically excludes liability for consequential damages or for charges for labor or expense in making repairs or adjustments, or losses of time or inconvenience.

---

This warranty gives you specific legal rights and you may also have other legal rights which may vary from state to state. H.E. Anderson Company does not authorize any person to create for it any other obligation or liability in connection with these products. ANY IMPLIED WARRANTY APPLICABLE TO THESE PRODUCTS IS LIMITED TO THE DURATION OF THIS WARRANTY. H.E. Anderson Company shall not be liable for consequential damages resulting from breach of this written warranty.

NOTE: Some states do not allow limitation on how long an implied warranty will last or the exclusion of limitations of incidental or consequential damages, so the above limitations or exclusions may not apply to you.

---

## WHAT TO DO IF THERE IS A QUESTION REGARDING WARRANTY

- 1) Promptly notify the consumer adviser at H.E. Anderson Company by telephone at 800-331-9620 or 918-687-4426.
- 2) Confirm the report in writing (or via FAX at 918-682-3342) to the H.E. Anderson Company, stating the circumstances surrounding the problem.

## PURCHASER'S OBLIGATION

- a) Purchaser must give H.E. Anderson Company immediate written notice on discovery of defect.
- b) Purchaser must pay for shipment of the defective product to the H.E. Anderson Company, 2100 Anderson Drive, Muskogee, Oklahoma 74403.